

*"Elevate Performance with Premium Lifting Tackles."*

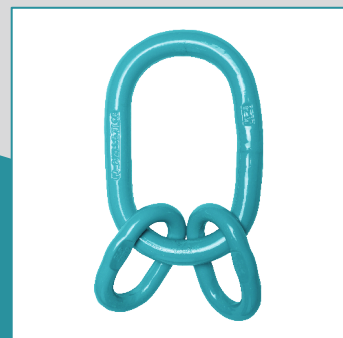



## COMPANY PROFILE :

UTKAL ENGINEERS established in 2003, is an ISO 9001, ISO 14001 & OHSAS 18001 certified company having manufacturing unit of over 50,000 Sq. Ft. area.

We are India's pioneer Manufacturers, Exporter of Material Handling, Lifting & Rigging products with Unique & Multiple variants. We have manufacturing facility of Wire Rope, Chain and Polyester slings and also testing facility up to 100 tons.

We offer vast range of product suitable for the movement & handling of product during production, distribution, consumption and logistics to increase the efficiency and reduce the man power thereby saving time & cost with safety. We serve heavy Engineering, Construction, Infrastructure, Cargo handling marine, mining & Transportation Industries.

## OUR VISION & MISSION :

We upto our entire resources at work to design, develop, discover, procure, test and serve to make sure that not just our client but the material handling industry of India grow profoundly and endure strongly the challenges coming from markets.

Our aim to take material handling industry forward with unique, cost effective & customized solution for all type of lifting / lashing chocking and festooning equipments.

We are committed to quality & services. We offer our technical support / training to educate our valuable clients & actual users to use proper tackle suitable for application, timely inspection and maintenance of lifting / lashing equipment.

## QUALITY POLICY :

We are highly concern about quality and reliability of our product Scope of innovation and evolution is always kept at our industrial research and quality wing. A streamlines production process of material handling equipment is followed to ensure that products delivered to the clients are up-to-date, efficient and high performing.



# Manual Chain Hoist

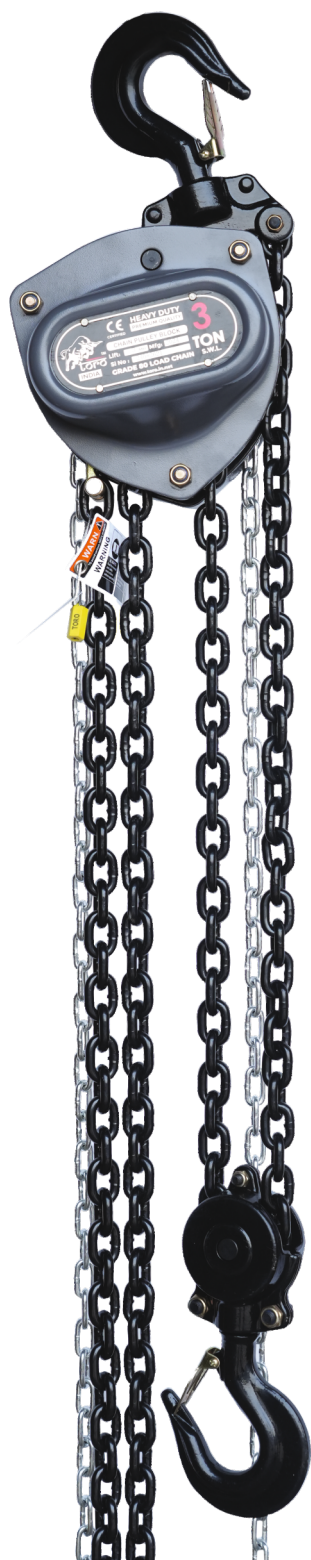

## STANDARD SPECIFICATION :

- High quality Bearings - 3 Bearings for 1 Ton, 4 Bearings from 2 Ton onwards.
- Strong Knight-head between plates and housing cover and reinforced hand wheel cover ensure increased stability.
- Zinc-plated and yellow-chromate brake parts and guide rollers ensure increased corrosion protection.
- Automatic double-pawl braking system.
- Overload 1.5 times of capacity one by one. Endurance Test 1500 Cycles.



Model	Capacity	Standard Lift	Test Load	Effort Required To Lift Max Load	No. of Falls of Load Chain	Load Chain Diameter	Dimension				Net Weight
	(Ton)	(Mtrs)	(T)	(N)	(Nos.)	(MM)	A	B	C	H	(KGS.)
TVDCPB0103	1	3	1.5	250	1	6	151	172	32	376	12.5
TVDCPB0203	2	3	3	335	1	8	175	210	36	470	19.5
TVDCPB0303	3	3	4.5	263	2	8	151	205	46	475	24
TVDCPB0503	5	3	7.5	360	2	10	189	280	46	688	41.3
TVDCPB1003	10	3	12.5	380	4	10	189	463	57	765	78.5
TVDCPB2003	20	3	20	435*2	8	10	192	630	82	890	193

Model	Capacity	Standard Lift
	(Ton)	(Mtrs)
TRLH075	0.75	1.5
TRLH150	1.5	1.5
TRLH300	3	1.5
TRLH600	6	1.5





**POLYESTER SLINGS**









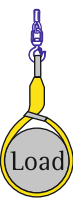
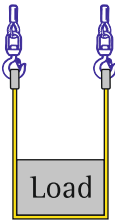
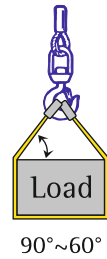
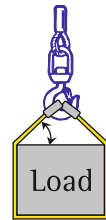
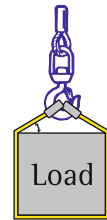

COLOUR CODE		POLYESTER WEBBING SLING				ROUND ENDLESS POLYESTER SLING		
		VERTICAL STRAIGHT LIFT	WIDTH	APPROX THICKNESS		VERTICAL STRAIGHT LIFT	APPROX WIDTH	APPROX THICKNESS
VIOLET		1000 KGS	25 MM	7 MM	1000 KGS	40 MM	6 MM	
GREEN		2000 KGS	50 MM	7 MM	2000 KGS	50 MM	7 MM	
YELLOW		3000 KGS	75 MM	7 MM	3000 KGS	60 MM	8 MM	
GREY		4000 KGS	100 MM	7 MM	4000 KGS	70 MM	9 MM	
RED		5000 KGS	125 MM	7 MM	5000 KGS	75 MM	11 MM	
BROWN		6000 KGS	150 MM	7 MM	6000 KGS	80 MM	12 MM	
BLUE		8000 KGS	200 MM	7 MM	8000 KGS	90 MM	13 MM	
ORANGE		10000 KGS	250 MM	7 MM	10000 KGS	100 MM	15 MM	
ORANGE		12000 KGS	300 MM	7 MM	12000 KGS	110 MM	16 MM	
ORANGE		15000 KGS	380 MM	7 MM	-	-	-	

- WEBBING & ROUND ENDLESS SLINGS ARE MANUFACTURED AS PER IS-15041-2001, BS EN 1492-1-2000
- WEBBING SLINGS UPTO 80 TONS & ROUND ENDLESS SLINGS UPTO 500 TONS AVAILABLE ON REQUEST

**HOW TO ORDER**

- WEBBING SLINGS WITH EYE LOOPS
  - VERTICAL CAPACITY IN TON & EFFECTIVE LENGTH (LOOP TO LOOP IN MTRS)
- ROUND ENDLESS SLINGS
  - VERTICAL CAPACITY IN TON & CIRCUMFERENTIAL LENGTH OR EFFECTIVE LENGTH (HALF OF CIRCUMFERENCE LENGTH)

**LIFTING CAPACITY OF WEBBING & ROUND ENDLESS SLINGS IN DIFFERENT MODE OF APPLICATIONS**

COLOR CODE	WLL (Ton)	WORKING LOAD LIMIT (W.L.L)					
		VERTICAL	CHOKER	BASKET	SINGLE BASKET WITH ANGLE		
		M = 1.0	M = 0.8	M = 2.0	M = 1.7	M = 1.4	M = 1.0
	1						
	2	1	0.8	2	1.7	1.4	1
	3	2	1.6	4	3.4	2.8	2
	4	3	2.4	6	5.1	4.2	3
	5	4	3.2	8	6.8	5.6	4
	6	5	4.0	10	8.5	7.0	5
	8	6	4.8	12	10.2	8.4	6
	10	8	6.4	16	13.6	11.2	8
	10	10	8.0	20	17.0	14.0	10

IF SWL = M



## G80 MASTER LINK :

- Standard : EN1677-4 (Supersedes DIN5688-3) • Super alloy steel-Quenched and Tempered • Individually proof test at 2.5 times Working Load Limit • Breakage test and fatigue test • 100% magnaflux crack detection • Surface finish : Powder plastified • Colour Code : Red RAL3020 / Yellow RAK1003 • Suitable for 1 or 2 legs G80 chain sling as per EN818-4 • BLUE AREA : WELDED • YELLOW AREA : FORGED

## TTSLR033-G80 EUROPEAN TYPE G80 MASTER LINK

## TSLR033



ITEM NO.	WEIGHT (K.G.)	WILL (T)	A	B	C	S X H
8-TSLR-33-76-8	0.34	1.6	110	60	13	7 + 0.3 X 25
8-TSLR-33-76-8B	0.43	1.6	140	80	13	7 + 0.3 X 25
8-TSLR-33-87-8	0.54	2.12	110	60	16	7 + 0.5 X 25
8-TSLR-33-87-8B	0.66	2.12	140	80	16	7 + 0.5 X 25
8-TSLR-33-108-8	0.823	3.15	135	75	18	8 + 0.5 X 28
8-TSLR-33-108-8B	1.1	3.15	180	120	18	8 + 0.5 X 28
8-TSLR-33-1310-8	1.5	5.3	160	90	22	11 ± 0.5 X 35
8-TSLR-33-1310-8B	1.68	5.3	180	120	22	11 ± 0.5 X 35
8-TSLR-33-1613-8	2.32	8	180	100	26	13 ± 0.5 X 43
8-TSLR-33-1816-8	3.95	11.2	200	110	32	13 ± 0.5 X 55
8-TSLR-33-2018-8	6.34	14	260	140	36	19 ± 0.5 X 60
8-TSLR-33-2220-8	8.96	17	300	160	40	20 ± 0.5 X 64
8-TSLR-33-2622-8	12.8	21.2	340	180	45	---
8-TSLR-33-3226-8	16.55	31.5	350	190	50	---
8-TSLR-33-3632-8	23.28	45	400	200	56	---
8-TSLR-33-4036-8	32	56	430	220	63	---
8-TSLR-33-72-8	45.76	63	460	250	72	---

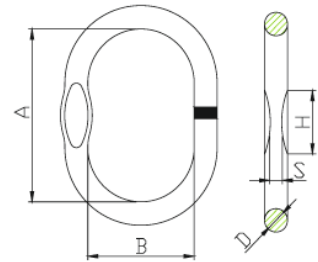

## TSLR032-G80 EUROPEAN TYPE G80 MASTER LINK ASSEMBLY

## TSLR032



ITEM NO.	WEIGHT (K.G.)	WILL (T)	A	B	D	a	b	c	S X H
8-TSLR-32-W-6	1.18	2.36	135	75	18	54	25	13	7 + 0.3 X 25
8-TSLR-32-W-7	1.24	3.15	135	75	18	60	38	13	7 + 0.5 X 25
8-TSLR-32-W-8	2.2	4.25	160	90	22	70	34	16	8 + 0.5 X 28
8-TSLR-32-W-10	3.4	6.7	180	100	26	85	40	18	11 ± 0.5 X 35
8-TSLR-32-W-13	6.1	11.2	200	110	32	115	50	22	13 ± 0.5 X 43
8-TSLR-32-W-16	9.98	17	260	140	36	140	65	26	17 ± 0.5 X 55
8-TSLR-32-W-18B	19.1	19.5	300	160	40	270	140	32	18 ± 0.5 X 59
8-TSLR-32-W-18C	19.4	21.2	340	180	45	160	90	32	18 ± 0.5 X 59
8-TSLR-32-W-18	18.9	21.2	340	180	45	180	100	32	18 ± 0.5 X 59
8-TSLR-32-W-20C	23.1	26.5	350	190	50	160	90	32	18 ± 0.5 X 59
8-TSLR-32-W-20	23.7	26.5	350	190	50	180	100	32	20 ± 0.5 X 64
8-TSLR-32-W-22	25.2	31.5	350	190	50	180	100	36	---
8-TSLR-32-W-26	35.2	45	400	200	56	180	100	40	---
8-TSLR-32-W-28	47	50	430	220	63	180	100	45	---
8-TSLR-32-W-32	66.46	67	460	250	72	200	110	50	---

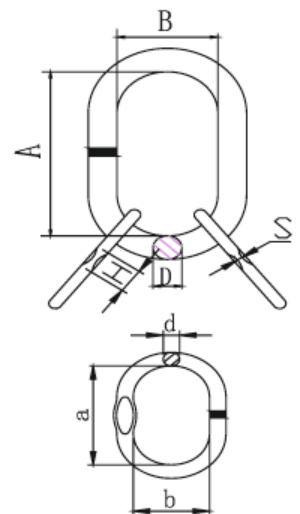



## G80 EYE SLING HOOK

- Forged super alloy steel - quenched and Tempered • Suitable for EN818-2 G80 Chain • Individually proof test at 2.5 times working load limit • Fatigue tested at 1.5 times working load for 20000 cycles • Breakage test • 100% magnaflux crack detection • with cast latch • Surface finish : Powder plastified • Colour code : Red RAL3020 / Yellow RAL1003

## TSLR334-EY SLING HOOK WITH LATCH

## TSLR334



ITEM NO.	WEIGHT (K.G.)	WILL (T)	B.L. (T)	M±2	A±2	E±2	H±3	B±3	L±3	D±3
8-TSLR-334-06	0.3	1.12	4.48	20.5	9	18.5	20	68	109	17
8-TSLR-334-7/8	0.55	2	8	25	11	22	27	84	133.5	24
8-TSLR-334-10	1.05	3.15	12.6	34	14	28	33	102.5	167.5	29
8-TSLR-334-13	1.75	5.3	21.2	42.5	17.5	35	40	128.5	207.5	36
8-TSLR-334-16	3.2	8	32	52	22	43	48	156.5	253	50
8-TSLR-334-20	5.3	12.5	50	62	26	51.5	56	187	300	60

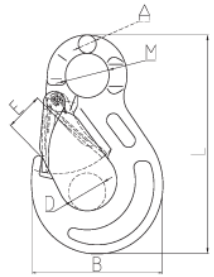

## TSLR074-G80 CONNECTING LINK

## TSLR074



ITEM NO.	WEIGHT (K.G.)	WILL (T)	B.L. (T)	A±1.5	B±1	L±2.5	K±2	H±1
8-TSLR074-6	0.08	1.12	4.48	15	7.5	58	42	7
8-TSLR074-7	0.145	1.5	6	20	8.5	73	54.8	8.5
8-TSLR074-7/8	0.146	2	8	20.5	9.5	79.5	60.5	8.5
8-TSLR074-8	0.16	2	8	20.5	9.5	79.5	60.5	8.5
8-TSLR074-10	0.30	3.15	12.6	26	12	90.5	68	11.5
8-TSLR074-13	0.65	5.3	21.2	30	15	117	87	15
8-TSLR074-16	1.15	8	32	35	19.8	148	108.4	19.8
8-TSLR074-18	1.84	10	40	38	21	154	112	21
8-TSLR074-20	2.1	12.5	50	41	24	169.5	121.5	24
8-TSLR074-22	2.87	15	60	49.5	26	193.5	141.5	26
8-TSLR074-26	4.5	21.2	84.8	57.5	31	220	158	30
8-TSLR074-32	8.21	31.5	126	67.5	38	281	205	37

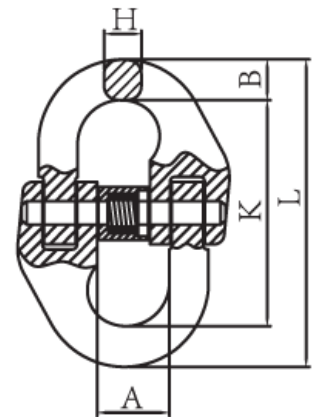

## TSLR333-G80 CLEVIS SLING HOOK WITH CAST LATCH

## TSLR333



ITEM NO.	WEIGHT (K.G.)	WILL (T)	B.L. (T)	A±05	B±1.2	E±1	H±2	M±1	L±2
TSLR333-6	0.3	1.12	4.48	8	32	19.5	20	68	108
TSLR333-7/8	0.55	2	8	9.5	38.5	24	25	87.4	129.5
TSLR333-10	0.96	3.15	12.6	12.5	48	28	36	106.7	163.5
TSLR333-13	1.52	5.3	21.2	16	56	35	41.6	130	195.5
TSLR333-16	3.43	8	32	18.5	65.5	43	46.2	155.5	236
TSLR333-20	6.73	12.5	50	24.5	92	51.6	51	180	281

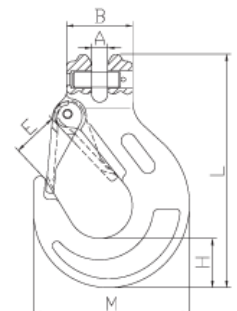



## G80 EYE TYPE SAFETY HOOK :

- Forged super alloy steel - Qyenched and Tempered • Suitable for EN818-2 G80 chain • Individually proof test at 2.5 times Working Load Limit • Fatiuge tested at 1.5 times Working Load for 20000 cycles • Breakage test • 100% magnaflux crack detection • Surface finish : Powder plastified • Colour Code : Red RAL3020 / Yellow RAL1003 • G 8 0 SELF-LOCK HOOK IMPROVED • Positive Lock latch is Self-Locking when hook is loaded

## TSLR737-EYE TYPE SAFETY HOOK

## TSLR737

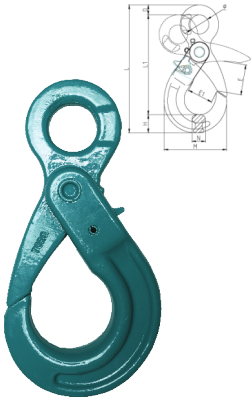

ITEM NO.	WEIGHT (K.G.)	WILL (T)	B.L. (T)	E	E	E1	L1	L	H	D	N	M
8-TSLR-737-06	0.5	1.12	4.48	21±1	32±2	28±1	110±3	140±3	20±1	11±0.5	15±0.5	73±2
8-TSLR-737-7/8	0.85	2.	8	25±1	40±3	35±1	136±3	175±3	26±1	13±0.5	20±0.5	91±2
8-TSLR-737-10	1.42	3.15	12.6	34.5±1.5	48±3	45±1.5	168±3	213±3	30±1.5	15±0.5	26±1	108±2
8-TSLR-737-13	2.86	5.3	21.2	39.5±1.5	27±3	52.5±2	207±4	267±3	40±1.5	21±0.5	33±1	142±3
8-TSLR-737-16	5.9	8	32	50±2	65±3	63±2	254±4	332±4	50.5±2	27±0.5	38±2	168.6±3
8-TSLR-737-20	8.5	12.5	50	64.5±2	82±3.5	82±2	278±5	360±5	55±2	27±0.5	50±2	185±4
8-TSLR-737-22	11.6	15	60	70±3	80±3.5	76±2	319±5	415±5	67±2	32±1	52±2	202±4
8-TSLR-737-26	18	21.2	84.8	80±3	109±3.5	96±3	362±6	472±5	75±3	34±1	60±3	239±5
8-TSLR-737-32	46	31.5	126	105±4	131±3.5	131±3	470±6	614±5	97±3	45±1	79.5±3	329±5

## TSLR116-G80 EYE FOUNDRY HOOK

## TSLR116

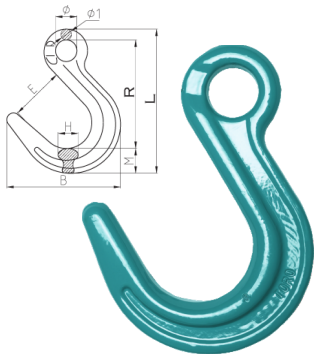

ITEM NO.	WEIGHT (K.G.)	WILL (T)	B.L. (T)	0±1	L±3	B±2	R±2	E±1	1±1	H±2	M
8-TSLR116-1.12T	0.382	1.12	4.48	20	133	100	102.7	49	10	17	19
8-TSLR116-2.0T	0.69	2	8	24	158.5	130	120.5	62	12	19	26
8-TSLR116-3.2T	1.3	3.2	12.8	31.5	199	152.5	153	73	15	25	31
8-TSLR116-5.3T	2.32	5.3	21.2	44	241.5	186	184	90	19	33	39
8-TSLR116+8T	4	8	32	49	279	218	216	105	22	37	42
8-TSLR116-12.5T	7.3	12.5	50	60	330	252	247	114	26	46	57
8-TSLR116-15T	11.4	15	60	64	376	274	275	123	31	60	70

## TSLR132-FORGED SWIVEL HOOK

## TSLR132



ITEM NO.	WEIGHT (K.G.)	ALLOY		CARBON		A±1	B±2	E±2	H±0.6	K±4	L±5	M±1
		WILL (T)	B.L. (T)	O	E							
TSLR-132-A0.75T/C0.5T	0.3	0.75	3.375	0.5	2.5	32	22.5	17	9	110	137	15
TSLR-132-A1T/C0.75T	0.34	1	4.5	0.75	3.75	32	22.5	17	9	108	136	16
TSLR-132-A1.5T/C1T	0.64	1.5	6.75	1	5	37.5	29.5	22.5	12	130	163.5	17.5
TSLR-132-A2T/C1.5T	1.05	2	9	1.5	7.5	42.5	33	21.5	15.8	150	192	21
TSLR-132-A3T/C2T	1.24	3	13.5	2	10	42.5	33	26	15.8	163	209	23
TSLR-132-A5T/C3T	2.3	5	22.5	3	15	48	39	32.5	18	191	246	33
TSLR-132-A7T/C5T	4	7	31.5	5	25	64	53	43	21.5	243.5	313	34
TSLR-132-A11T/C7.5T	7.09	11	49.5	7.5	37.5	68	53	49.5	26	277	364	41.5
TSLR-132-A15T/C15T	12.77	15	67.5	10	50	79	62	54.5	32	332	431	55.7
TSLR-132-A22T/C15T	24.5	22	99	15	75	105	108	87	40	427	543	70
TSLR-132-A30T/C20T	34.5	30	135	20	105	105	96	97.5	40	465	596	76.2



## G80 FORGED SWIVEL HOOK

- Forged alloy steel or carbon steel • Breakage test • 100% magnaflux crack detection • With safety latch • Surface finish : Powder plastified • Colour code : Red RAL3020 / Yellow : RAL1003 • Alloy Steel : Ultimate load is 4.5 times the Working Load Limit • Carbon Steel : Ultimate load is 5 times the Working Load Limit • Can be Rotated under Non-load Conditions!

### TSLR313 G80 CLEVIS GRAB HOOK WITH SAFETY PIN

## TSLR313



ITEM NO.	WEIGHT (K.G.)	WILL (T)	B.L. (T)	A±0.5	B±1.2	E±0.5	M±2	L±2
TSLR313 - 6	0.28	1.12	4.48	8	32	8	43.5	75
TSLR313 - 7/8	0.33	2	8	9.5	35	11	50	89
TSLR313 - 10	0.88	3.15	12.6	12.5	45.5	13	72	126.5
TSLR313 - 13	1.85	5.3	21.2	15	53	16.5	96	163.5
TSLR313 - 16	3.24	8	32	18.5	69.5	19	112.5	183.5

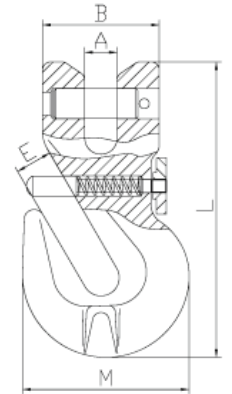

### TSLR303 G80 LIFTING SCREW POINT

## TSLR303

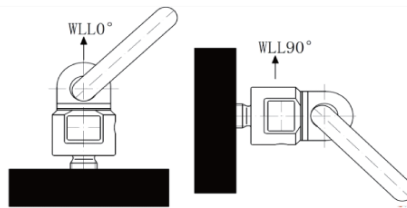
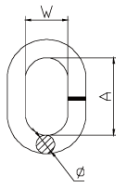
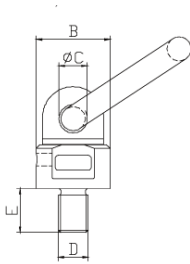
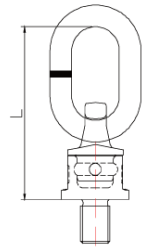



# G100 CHAIN SLING



ITEM NO.	WLL/T	B.L/T	D(mm)	t(mm)	b1(mm) min	b1(mm) max
6mm	1.4	5.6	6±0.24	18±0.5	8.7	21.6
7mm	1.9	7.6	7±0.28	21±0.6	9.5	25.2
8mm	2.5	10	8±0.32	24±0.7	10.9	28.8
10mm	4	16	10±0.4	30±0.9	13.5	36
13mm	6.7	26.8	13±0.52	39±1.2	17.5	46.8
16mm	10	40	16±0.64	48±1.4	21.5	57.6
19mm	14	56	19±0.90	57±1.6	25.6	68.4
22mm	19	76	22±1.10	66±2.0	29.5	79.2
26mm	26.5	106	26±1.30	78±2.3	33.8	96.2
32mm	39.3	157.2	32±1.60	96±2.9	41.6	118

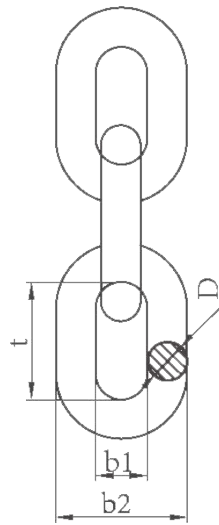

## G100 MASTER LINK

- Forged super alloy steel - Quenched and Tempered • Suitable for G100 chain • 25% stronger than G80
- Individually proof test at 2 times Working Load Limit • Fatigue tested at 1.5 times working load limit for 20000 cycles • Breakage test • 100% magnaflux crack detection • surface finish : Powder plastified

## TSLR1013-G100 FORGED MASTER LINK

## TSLR1013

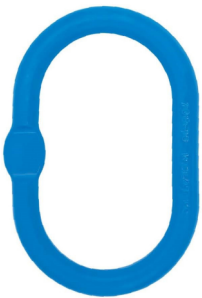

ITEM NO.	WEIGHT (K.G.)	WLL (T)	A	B	D	SXH
10-TSLR1013-06	0.23	1.4	100±4	60±4	11+1	6+0.5X22
10-TSLR1013-86	0.4	2.5	120±5	70±4	13+1	7+0.5X25
10-TSLR1013-108	0.7	4	140±5	80±4	17+1	8+0.5X28
10-TSLR1013-1310	1.5	7.5	160±5	95±4	22+1	11±0.5X35
10-TSLR1013-16	2.2	10	190±5	110±5	26+1-1	13±0.5X43
10-TSLR1013-1613	2.51	12.5	180±5	100±5	27+1	14±0.5X46
10-TSLR1013-2016	5.1	17	240±6	140±5	32+1	17±0.5X55
10-TSLR1013-2220	7.2	25	250±6	150±5	38+2-1	21±0.5X65
10-TSLR1013-2622	8.3	26.5	250±6	150±5	41+2-1	23±0.5X73
10-TSLR1013-3226	13.6	39.3	300±6	180±5	48+2-1	27±0.5X85

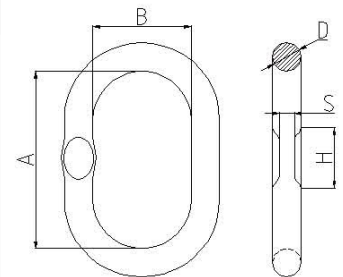

## TSLR1014-G100 FORGED OVERSIZED MASTER LINK

## TSLR1014



ITEM NO.	WEIGHT (K.G.)	WLL (T)	A	B	D	SXH
10-TSLR1014-10	3.7	4	340	180	25	13.5+0.5X40
10-TSLR1014-13	4.7	6.7	340	180	28	15±0.5X48
10-TSLR1014-16	7.0	10	340	180	34	18±0.5X55
10-TSLR1014-20	8.9	16	340	180	38	20±0.5X60

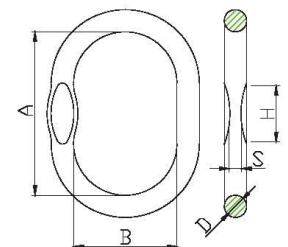



## G100 MASTER LINK

- Forged super alloy steel - Quenched and Tempered
- Suitable for G100 chain
- 25% stronger than G80
- Individually proof test at 2 times Working Load Limit
- Fatigue tested at 1.5 times working load limit for 20000 cycles
- Breakage test
- 100% magnaflux crack detection
- surface finish : Powder plastified

### TSLR1012-G100 MASTER LINK ASSEMBLY

### TSLR1012

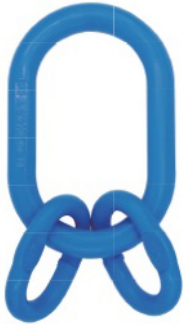

ITEM NO.	G100 CHAIN	WEIGHT (KG)	WILL (T)	A	B	D	a	b	c
8-TSLR1012-6	6MM	1.3	3	135	75	19	54	25	13
8-TSLR1012-8	8MM	2.33	5.3	160	90	23	70	34	16.5
8-TSLR1012-10	10MM	3.7	8	180	100	27	85	40	19
8-TSLR1012-13	13MM	6.5	14	200	110	33	115	50	23
8-TSLR1012-16	16MM	10.1	21.2	260	140	36	140	65	27
8-TSLR1012-20	19/20MM	22.8	33.6	350	190	50	180	90	33
8-TSLR1012-22	22MM	26	39.9	350	190	50	180	100	36

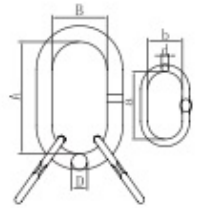

### TSLR1015-G100 MASTER LINK ASSEMBLY

### TSLR1015



ITEM NO.	WEIGHT (KG)	WILL (T)	B.L. (T)	A	B	D	a	b	c
10-TSLR1015-06	1.8	3.5	14	150±5	90±4	19±1.5	120±5	70±4	14±1.5
10-TSLR1015-08	3	5	20	160±5	96±4	22±1.5	140±5	80±4	18±1.5
10-TSLR1015-10	6.5	11.5	46	200±5	120±5	30±1.5	160±5	95±4	22±1.5
10-TSLR1015-13	15	17	68	250±6	150±5	40±2	190±5	110±5	26±1.5
10-TSLR1015-16	23	28	112	300±6	200±5	50±2	200±5	120±5	32±2

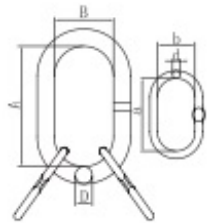

### TSLR1001-G100 EUROPEAN TYPE CONNECTING LINK

### TSLR1001



ITEM NO.	WEIGHT (K.G.)	WILL (T)	B.L. (T)	A	B	C	D	K	H
10-TSLR1001-06	0.08	1.4	5.6	14±0.8	16.9±0.8	85±0.8	7±0.5	44.5±2	11+0.5-1
10-TSLR1001-07	0.16	1.9	7.6	18.5±0.8	22.5±0.8	10±0.8	8.2±0.5	59±3	12.5+0.5-1
10-TSLR1001-7/8	0.17	2.5	10	18.5±0.8	22±0.8	11±0.8	8.5±0.8	59±3	13+0.5-1
10-TSLR1001-08	0.18	2.5	10	18.5±0.8	22.7±1	10.5±0.8	10±0.8	63±3	14+0.5-1
10-TSLR1001-10	0.34	4	16	23±1	27.7±1	12.6±1	12.6±1	71±3	18+0.8-1
10-TSLR1001-13	0.68	6.7	26.8	28±1	33.2±1	16.5±1	16.5±1	92.5±3	23+0.8-1
10-TSLR1001-16	1.22	10	40	33.5±1	39±2	20±1	20±1	106.5±3	29.5±1
10-TSLR1001-20	2.13	16	64	42±1	47.3±3	25±1.5	25±1.5	123±3	35.5±1.5
10-TSLR1001-22	3	19	76	48±1	55±3	27±1.5	27±1.5	137.5±3	39±2
10-TSLR1001-26	5.22	26.5	106	61±2	68±3	32±2	32±2	163±4	45±2.5
10-TSLR1001-32	9.55	39.3	157.2	80±2	87±3	40±3	40±3	197±4	54±3

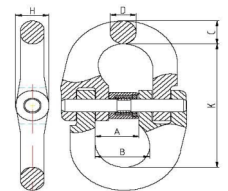

## G100 CONNECTING LINK

- Forged super alloy steel - Quenched and Tempered • Suitable for G10 Chain • Individually proof test at 2.5 times Working Load Limit • Fatigue test at 1.5 times Working Load Limit for 20000 cycles • Breakage test • 100% magnaflux crack detection
- All load pins are 100% individually inspected and tested • Surface finish : Powder plastified



## TSLR1004-G100 CLEVIS SLING HOOK WITH CAST LATCH

## TSLR1004



ITEM NO.	WEIGHT (K.G.)	WILL (T)	B.L. (T)	A±0.5	B±1	E±1.5	H±1	M±2	L±2.5
10-TSLR1004-06	0.33	1.4	5.6	7.5	32	18.5	21	68.5	109
10-TSLR1004-08	0.7	2.5	10	9.5	37	25	27.5	88	134
10-TSLR1004-10	1.3	4	16	12	48	28	33.5	105.5	161.5
10-TSLR1004-13	2.3	6.7	26.8	15	59	38	42	134	203
10-TSLR1004-16	3.6	10	40	18.5	70	44	50	160.5	248
10-TSLR1004-20	7	16	64	25	85	52	56	190.5	297
10-TSLR1004-22	12.1	19	76	27	100	66	62	214.5	326

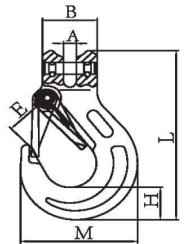

## TSLR1067-G100 MASTER LINK WITH DOUBLE GRAB HOOK

## TSLR1067



ITEM NO.	WEIGHT (KG)	WILL (T)	B.L. (T)	A	B	D	2
10-TSLR1067-6	1.04	2	8	120	70	14	TSLR1051 6 - 10 X 2
10-TSLR1067-8	2.12	3.55	14.2	140	80	17	TSLR1051 8 - 10 X 2
10-TSLR1067-10	4.15	5.6	22.4	160	95	22	TSLR1051 10 - 10 X 2
10-TSLR1067-13	7	9.5	38	190	110	25	TSLR1051 13 - 10 X 2
10-TSLR1067-16	13.48	14	56	230	130	32	TSLR1051 16 - 10 X 2

## TSLR1068-G100 MASTER LINK ASSEMBLY WITH GRAB HOOK

## TSLR1068



ITEM NO.	WEIGHT (KG)	WILL (T)	B.L. (T)	1	2
10-TSLR1068-6	2.5	3	12	TSLR-1012 6 - 10	TSLR1051 6 - 10 X 4
10-TSLR1068-8	5.09	5.3	21.2	TSLR-1012 8 - 10	TSLR1051 8 - 10 X 4
10-TSLR1068-10	9.02	8	32	TSLR-1012 10 - 10	TSLR1051 10 - 10 X 4
10-TSLR1068-13	15.94	14	48	TSLR-1012 13 - 10	TSLR1051 13 - 10 X 4
10-TSLR1068-16	28.1	21.2	84.4	TSLR-1012 16 - 10	TSLR1051 16 - 10 X 4





## ***Utkal Engineers***

### **Registered Office :**

904-B-Square I, 9th Floor, Near Neptune House, Vikram Nagar, Iskon-Ambali Rd, Ahmedabad-380058. (GUJARAT) INDIA

Phone : +91-079-26730115, 02717 430517 • Mobile : +91 98250 18658

E-mail : [utkal\\_engineers@yahoo.com](mailto:utkal_engineers@yahoo.com), [info@utkalengineers.com](mailto:info@utkalengineers.com) • Website : [www.utkalengineers.com](http://www.utkalengineers.com)

### **Manufacturing Unit :**

421/2, Opp. Rotomac, Parikh Packaging Lane, Moraiya, Ta. Sanand, Ahmedabad-382213. (Gujarat)

### **Branch Office :**

7, Sahajanand Arcade, 363-364, GIDC Makarpura, Beside Hanuman Temple, Makarpura, Vadodara-390010. (Gujarat)

**FOR TORO PRODUCT INQUIRY : 6357770010 | E-mail : [toroliftingindia@gmail.com](mailto:toroliftingindia@gmail.com) | [www.toro.in.net](http://www.toro.in.net)**